



水務署

Water Supplies Department

香港灣仔告士打道七號入境事務大樓
Immigration Tower, 7 Gloucester Road, Hong Kong

電子郵遞
e-mail wsdinfo@wsd.gov.hk

電話
Telephone 2829 4367

圖文傳真
Facsimile 2824 0578

檔號
Reference (2) in WSD 3321/16 Pt.1 T/J(928)

5 July 2016

Approval of “VOLA” Manually Operated Blending Valves

Your letter ref. HW/16035/KL/eh dated 13 June 2016 refers.

It is noted that the fittings described below have been accepted by the United Kingdom Water Regulations Advisory Scheme (WRAS) to have complied with the requirements of the United Kingdom Water Supply (Water Fittings) Regulations / Scottish Water Byelaws when correctly installed.

Name of Manufacturer: Vola A/S

Country of Origin: Denmark

Brand: Vola

Details of Fittings: Range of wall mounted, concealed, manually operated blending valves (chromium plated brass bodies), incorporating a ceramic cartridge headwork with single lever operating members. Maximum working pressure 5.0 bar. Maximum operating temperature 70°C.

Models: Vola 500 & 2500

Size: 10mm spigot

Marking: 'Vola' on operating member

WRAS Approval Number: 1606701

Installation Requirements: R001, R009, R040

Expiry Date: 30 June 2021

In view of the acceptance by WRAS, this Authority has no objection to the use of the said fittings in fresh water supply plumbing systems subject to full adherence to Waterworks installation requirements. In particular, you are required to draw your customers' attention to the following installation requirements –

“Installation shall comply with the ‘Installation Requirements & Notes’ of the WRAS’s approval letter concerned.” AND

“The cold water supply to the fittings shall be drawn from the same source that supplies the hot water apparatus so as to provide a balanced pressure and to obviate the risk of scalding in the event of a restriction or failure in the water supply.”

A condition of this acceptance is that the fittings to be installed should be replicas of the samples certified by WRAS and no modification should be made to the fittings. This acceptance may be withdrawn at any time if the standard of the fittings installed fails to meet that of the approved samples or if the fittings are found to be unsuitable for use in fresh water supply plumbing systems.

This acceptance is only applicable to the main body of the fittings, unless other specified.

For the use of the fittings in any project, the Acceptance Reference Number at the bottom of this letter must be quoted as a means of identification of acceptance of the fittings by this Authority.

Should you have any enquiries, please contact our Engineer Mr Terry KUNG at tel. no. 2294 2656.

Yours faithfully,



(LAM Ching Man)
for Water Authority

c.c. WSD 3321/1/82] - without catalogue
ME/CS(MC)] - with soft copy only

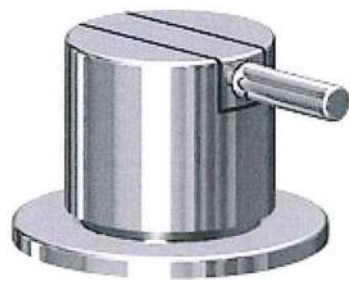

VOLA 500



VOLA 2500